

Standard fittings, IP 67, nickel plated brass

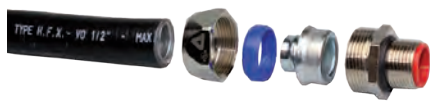

ANACONDA NICKEL PLATED BRASS FITTINGS FOR ANACONDA SEALTITE

Anaconda standard nickel plated brass fittings can be used with all types of Anaconda SealTite (except CNP). This Anaconda fitting is an universal fitting and offers excellent corrosion protection in combination with a nice appearance. Because of the UL & CSA approvals the fittings are also suitable for export projects outside Europe.

Material & Construction:

Construction: Nickel plated brass fitting, consisting of 4 parts (counter nut, clamping ring, ferrule and body).

Material: Counter nut, body and ferrule are nickel plated brass with exception of size 3/8" till 1" where the ferrule is from galvanised steel. Clamping ring and inserts are made from PA6 (red for ISO metric, blue for Pg and white for NPT).

Special approvals: UL-514B and CSA C 22.2 (combined UL / CSA CUL) file # E 234207).

Suitable for use in hazardous environments according to NEC:

- Article 501.10 (B) (2) Class I, Division 2.

- Article 502.10 (A) (2) and (B) (2).

Class II, Division 1 and 2.

- Article 503.10 (A) (3) and (B).

Class III, Division 1 and 2.

Temperature: -45 °C till +105 °C continuous (cable-hose fittings are -40 °C till +100 °C).

Protection class: IP 67, with cable-hose fittings an IP 68 rate on the switchbox can be obtained.

Colour: Metal coloured.

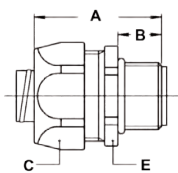

ISO straight fitting, male, nickel plated brass



| THREAD ISO | SEALTITE SIZE (INCH) | MIN. INTERNAL BORE (MM) | DIMENSIONS IN MM | | | | | STANDARD PACKAGE | ARTICLE NUMBER | WEIGHT (KG/100) |
|------------|----------------------|-------------------------|------------------|----|----|---|----|------------------|----------------|-----------------|
| | | | A | B | C | D | E | | | |
| M12 x 1,5 | 1/4" | 5,2 | 33 | 10 | 22 | - | 20 | 10 | 812.012.1* | 4,8 |
| M16 x 1,5 | 5/16" | 8,3 | 35 | 12 | 26 | - | 24 | 10 | 812.015.1* | 5,2 |
| M20 x 1,5 | 5/16" | 8,3 | 36 | 13 | 26 | - | 24 | 10 | 812.014.1* | 5,5 |
| M16 x 1,5 | 3/8" | 10,2 | 35 | 12 | 26 | - | 24 | 10 | 812.016.1 | 4,8 |
| M20 x 1,5 | 3/8" | 10,2 | 36 | 13 | 26 | - | 24 | 10 | 812.017.1 | 5,1 |
| M20 x 1,5 | 1/2" | 13,9 | 37 | 13 | 29 | - | 27 | 10 | 812.020.1 | 5,9 |
| M25 x 1,5 | 3/4" | 18,5 | 40 | 15 | 35 | - | 33 | 5 | 812.025.1 | 7,9 |
| M32 x 1,5 | 1" | 23,8 | 46 | 15 | 45 | - | 43 | 5 | 812.032.1 | 17,5 |
| M40 x 1,5 | 1 1/4" | 31,8 | 52 | 16 | 54 | - | 52 | 2 | 812.040.1 | 27,9 |
| M50 x 1,5 | 1 1/2" | 36,8 | 56 | 18 | 63 | - | 60 | 2 | 812.050.1 | 42,3 |
| M63 x 1,5 | 2" | 47,8 | 66 | 20 | 77 | - | 74 | 2 | 812.063.1 | 73,5 |

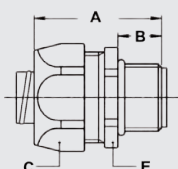

ISO straight fitting, small design, male, nickel plated brass



| THREAD ISO | SEALTITE SIZE (INCH) | MIN. INTERNAL BORE (MM) | DIMENSIONS IN MM | | | | | STANDARD PACKAGE | ARTICLE NUMBER | WEIGHT (KG/100) |
|------------|----------------------|-------------------------|------------------|----|----|---|----|------------------|----------------|-----------------|
| | | | A | B | C | D | E | | | |
| M12 x 1,5 | 1/4" | 5,2 | 33 | 10 | 19 | - | 17 | 10 | 812.012.2 | 2,8 |
| M16 x 1,5 | 1/4" | 5,2 | 35 | 12 | 19 | - | 19 | 10 | 812.013.2 | 3,4 |
| M12 x 1,5 | 5/16" | 8,3 | 33 | 10 | 22 | - | 20 | 10 | 812.011.2 | 3,6 |
| M16 x 1,5 | 5/16" | 8,3 | 35 | 12 | 22 | - | 20 | 10 | 812.015.2 | 3,8 |
| M20 x 1,5 | 5/16" | 8,3 | 36 | 13 | 22 | - | 24 | 10 | 812.014.2 | 4,2 |

* Sizes 1/4" and 5/16" do not have UL / CSA approval.

STANDARD FITTINGS, IP 67, NICKEL PLATED BRASS

ISO straight fitting, female, nickel plated brass

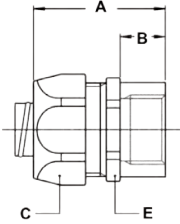

| THREAD ISO | SEALTITE SIZE (INCH) | MIN. INTERNAL BORE (MM) | DIMENSIONS IN MM | | | | | STANDARD PACKAGE | ARTICLE NUMBER | WEIGHT (KG/100) |
|------------|----------------------|-------------------------|------------------|----|----|---|----|------------------|----------------|-----------------|
| | | | A | B | C | D | E | | | |
| M16 x 1,5 | 5/16" | 8,3 | 35 | 12 | 26 | - | 24 | 10 | 812.315.1* | 5,4 |
| M16 x 1,5 | 3/8" | 10,2 | 35 | 12 | 26 | - | 24 | 10 | 812.316.1 | 5 |
| M20 x 1,5 | 1/2" | 13,9 | 37 | 13 | 29 | - | 27 | 10 | 812.320.1 | 7,6 |
| M25 x 1,5 | 3/4" | 18,5 | 40 | 15 | 35 | - | 33 | 5 | 812.325.1 | 9 |
| M32 x 1,5 | 1" | 23,8 | 46 | 15 | 45 | - | 43 | 5 | 812.332.1 | 18,3 |
| M40 x 1,5 | 1.1/4" | 31,8 | 52 | 16 | 54 | - | 52 | 2 | 812.340.1 | 29,3 |
| M50 x 1,5 | 1.1/2" | 36,8 | 56 | 18 | 63 | - | 60 | 2 | 812.350.1 | 41,2 |
| M63 x 1,5 | 2" | 47,8 | 66 | 20 | 77 | - | 74 | 2 | 812.363.1 | 71,8 |

ISO 45° fitting, male, nickel plated brass

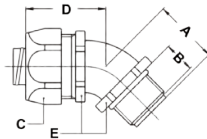

| THREAD ISO | SEALTITE SIZE (INCH) | MIN. INTERNAL BORE (MM) | DIMENSIONS IN MM | | | | | STANDARD PACKAGE | ARTICLE NUMBER | WEIGHT (KG/100) |
|------------|----------------------|-------------------------|------------------|----|----|----|----|------------------|----------------|-----------------|
| | | | A | B | C | D | E | | | |
| M16 x 1,5 | 5/16" | 8,3 | 23 | 12 | 26 | 33 | 22 | 10 | 812.415.1* | 7,7 |
| M20 x 1,5 | 5/16" | 8,3 | 24 | 13 | 26 | 33 | 22 | 10 | 812.414.1* | 7,8 |
| M16 x 1,5 | 3/8" | 10,2 | 23 | 12 | 26 | 33 | 22 | 10 | 812.416.1 | 7,3 |
| M20 x 1,5 | 3/8" | 10,2 | 24 | 13 | 26 | 33 | 22 | 10 | 812.417.1 | 7,4 |
| M20 x 1,5 | 1/2" | 13,9 | 25 | 13 | 29 | 33 | 27 | 10 | 812.420.1 | 10,5 |
| M25 x 1,5 | 3/4" | 18,5 | 30 | 15 | 35 | 36 | 33 | 5 | 812.425.1 | 13,6 |
| M32 x 1,5 | 1" | 23,8 | 34 | 15 | 45 | 46 | 42 | 5 | 812.432.1 | 26,5 |
| M40 x 1,5 | 1.1/4" | 31,8 | 39 | 16 | 54 | 54 | 51 | 2 | 812.440.1 | 44,9 |
| M50 x 1,5 | 1.1/2" | 36,8 | 45 | 18 | 63 | 59 | 60 | 2 | 812.450.1 | 67,5 |
| M63 x 1,5 | 2" | 47,8 | 53 | 20 | 77 | 71 | 74 | 2 | 812.463.1 | 128 |

ISO 90° fitting, male, nickel plated brass

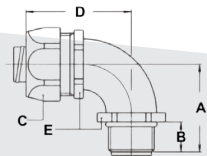

| THREAD ISO | SEALTITE SIZE (INCH) | MIN. INTERNAL BORE (MM) | DIMENSIONS IN MM | | | | | STANDARD PACKAGE | ARTICLE NUMBER | WEIGHT (KG/100) |
|------------|----------------------|-------------------------|------------------|----|----|----|----|------------------|----------------|-----------------|
| | | | A | B | C | D | E | | | |
| M16 x 1,5 | 5/16" | 8,3 | 32 | 12 | 26 | 42 | 22 | 10 | 812.915.1* | 8,6 |
| M20 x 1,5 | 5/16" | 8,3 | 33 | 13 | 26 | 42 | 22 | 10 | 812.914.1* | 8,8 |
| M16 x 1,5 | 3/8" | 10,2 | 32 | 12 | 26 | 42 | 22 | 10 | 812.916.1 | 8,2 |
| M20 x 1,5 | 3/8" | 10,2 | 33 | 13 | 26 | 42 | 22 | 10 | 812.917.1 | 8,4 |
| M20 x 1,5 | 1/2" | 13,9 | 36 | 13 | 29 | 43 | 27 | 10 | 812.920.1 | 12,6 |
| M25 x 1,5 | 3/4" | 18,5 | 43 | 15 | 35 | 48 | 33 | 5 | 812.925.1 | 19,2 |
| M32 x 1,5 | 1" | 23,8 | 48 | 15 | 45 | 59 | 42 | 5 | 812.932.1 | 31,6 |
| M40 x 1,5 | 1.1/4" | 31,8 | 57 | 16 | 54 | 68 | 51 | 2 | 812.940.1 | 56,1 |
| M50 x 1,5 | 1.1/2" | 36,8 | 63 | 18 | 63 | 78 | 60 | 2 | 812.950.1 | 85,3 |
| M63 x 1,5 | 2" | 47,8 | 74 | 20 | 77 | 96 | 74 | 2 | 812.963.1 | 139,8 |

* Sizes 1/4" and 5/16" do not have UL / CSA approval.