

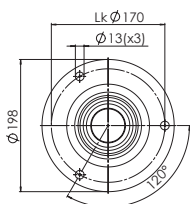

Virgo
SS 350 LED D

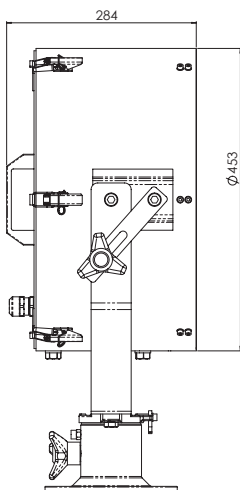

Technical Data

Name & No.	kg	Tilt	Description
Virgo SS 350 LED D	31,00	-40°/+30°	<ul style="list-style-type: none"> • IP 56 • housing, back plate and crutch made of stainless steel, base made of RG5, toughened soda-lime glass lens, parabolically lead coated mirror • all surfaces white powdercoated RAL 9016, internal surfaces are optical matt black • silikon gaskets • 19 white LED modules • input voltage: 85-264V AC, 120-370V DC or 24V DC • illuminated area in 100m: ø 5 x 5m • luminous flux: approx. 5.700 lm • peak beam candle power: approx. 2,6 x 10⁶ cd • beam angle: 3°, also available with 5° or 8° • light intensity in 100m: approx. 250 lx • pan: 370° • duability diode: 50.000 hours in continuous operation (manufacturer's data) • certification: German Lloyd • with electrical focus on request
Virgo SS 350 LED DP	43,50	-40°/+30°	
Virgo SS 350 LED C	36,50	-35°/+20°	
Virgo SS 350 LED CP	49,00	-35°/+20°	
Virgo SS 350 LED R	80,00	-35°/+20°	
Virgo SS 350 LED RP	99,00	-35°/+20°	

Optical Performance

Electric Voltage	Electric Power	Peak Beam Candle Power	Range M 1 Lux	Beam Angle
24V DC	80W	2,6 x 10 ⁶ cd	1.400 m	3°
110-120V AC	80W	2,6 x 10 ⁶ cd	1.400 m	3°
220-230V AC	80W	2,6 x 10 ⁶ cd	1.400 m	3°

Variations

Mounting Variations	Name	Description
Deck	D	• manual operation of searchlight
Cabin	C	• manual operation from below by control mechanism
Remote Control	R	• searchlight mounted on electric remote control unit complete with joystick, control panel for flush console installation
Pedestal	P	• searchlight on pedestal 1m high, special heights on request

Spare Parts on request

