



NEW

Pegasus LED Kit



polished version

Technical Data

Name & No.	Diagram	Wattage	kg	Description
Pegasus LED 105	O-	13W or 17W	4,50	<ul style="list-style-type: none"> • IP 56 • flat-type ceiling light with one integrated High Voltage/Mid Power LED module • brass casing and guard, clear glass bowl • cable gland: M24 x 1.5 • voltage: 230V, 115V or 24V DC • louninous flux: 13W: approx. 1.200 lm, 17W: approx. 1.600 lm • beam angle: approx. 160° • ambient temperature: -40° to +45° C • light colour: 6800K (cool white) • no power supply necessary, optimized thermal management • durability: up to 50.000 hours (manufacturer's data) depends on operating temperature
Pegasus LED 105/2	O=		4,60	
Pegasus LED Kit		13W or 17W	0,26	<ul style="list-style-type: none"> • change kit from Pegasus 105 to Pegasus LED 105: exchange in used lights without changing possible • consisting of: 1 High Voltage/Mid Power LED module, structured globe and mounting material • voltage: 230V, 115V or 24V DC

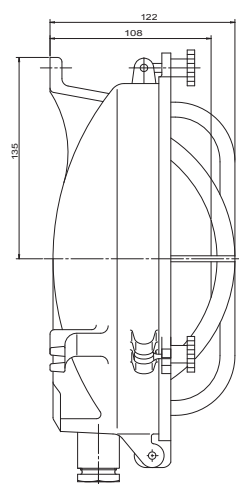

Spare Parts

No.	kg	Description
402	0,50	glass bowl 200x38mm

Polished products available for an extra charge.

