



CCBA/CRSA/CRBA

CCBA anti-track cable break out boots seal and protect cable and conduit breakouts

CRSA anti-track rain skirts reduce flash over potential in terminations and insulators

CRBA anti-track right angle boots seal and protect right angle terminations

Main Features

- Designed for Medium Voltage Applications to 36kV
- Shaped components to meet a variety of configuration requirements
- Meets ESI 09-13
- Continuous operating temperature: -55°C to 120°C
- Shrink temperature: 120°C





Technical Data

Physical

Property	Test Method	Typical Performance
Tensile Strength	ASTM D412	2600 psi (18 MPa)
Elongation	ASTM D412	600%
Heat Aging (500hrs. at 120°C)		
Tensile Strength	ASTM D412	2200 psi (15.2 MPa)
Elongation	ASTM D412	400%
Low Temperature Flexibility (-40°C)	ASTM D2671	No cracking
Flammability	ASTM D635	Non burning classification
Weatherometer	ASTM G-53	
Tensile	ASTM D412	2000 psi (13.8 MPa)
Elongation	ASTM D412	600%
Dielectric Strength	ASTM D412	375 V/mil (15 kV/mm)
Tracking Resistance	ASTM D2303	Non-tracking

Electrical

Dielectric Strength	ASTM D149, IEC 243	400 V/mil (16 kV/mm)
Volume Resistivity	STM D257	1.9 x 10 ¹⁶ ohm-cm
Track Resistance	ASTM D2303	Non-tracking

Chemical

Chemical Resistance		
Tensile Strength	ASTM D412	1900 psi (13 MPa)
Elongation	ASTM D412	640%

Dimensions

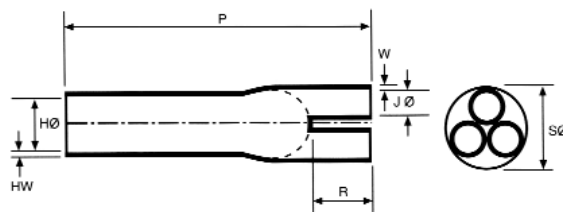

Breakouts

ORDER REF.	EXPANDED MIN		RECOVERED MAX		RECOVERED DIMENSIONS FULLY SHRUNK				
	H	J	H	J	S (NOMINAL)	P ±10%	R ±10%	HW ±20%	W ±20%
CCBA 220	55.8	30.4	23.5	9.5	37.0	180.0	44.0	3.0	2.0
CCBA 350	90.0	35.0	35.5	14.5	54.0	200.0	50.0	3.0	2.0
CCBA 430	110.0	40.0	35.5	18.0	55.0	230.0	45.0	4.0	3.0
CCBA 470	120.0	60.0	61.0	26.0	85.0	300.0	90.0	4.0	3.0

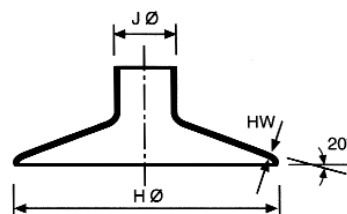

Rainsheds

ORDER REF. NO.	EXPANDED MIN	RECOVERED MAX	RECOVERED DIMENSIONS FULLY SHRUNK	
	J	J	H ±20%	HW ±20%
CRSA 170	44	15	95.0	3.0
CRSA 230	58	22	115.0	3.0
CRSA 300	76	31	135.0	3.0

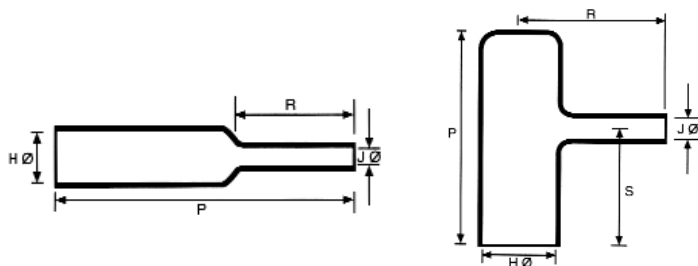

Breakouts

ORDER REF.	EXPANDED MIN		RECOVERED MAX		RECOVERED DIMENSIONS FULLY SHRUNK		
	H	J	H	J	P ±10%	R ±10%	S ±10%
STRAIGHT							
CRBA 335	85.0	45.0	41.5	21.0	240.0	120.0	
RIGHT ANGLE							
CRBA 335 L	85.0	45.0	43.0	21.0	183.0	150.0	110.0
CRBA 335 S	85.0	45.0	40.0	16.5	145.0	150.0	110.0

CANUSA

There's no end to what we cover

WORLDWIDE WEB: www.canusa-emi.com

All information contained in this leaflet is believed to be reliable. We advise however that customers should separately evaluate the suitability of our products for their particular application. CANUSA-EMI, Shaw Industries and DSG-Canusa GmbH & Co. KG give no guarantees in respect of the accuracy or sufficiency of the information presented and disclaim any liability regarding its use. Our responsibilities are only those listed in our Standard Terms and Conditions of Sale for these products. In no instance will we be liable for any eventual, indirect, or consequential damage or damages arising from the sale, resale, transfer, use or misuse of the product.

Ordering

Select a dimension which will shrink snugly over the component to be covered. If recovery is restricted the resultant wall thickness will be less than specified.