

LOCAL CONTROLLER

For Obelux LED Aviation Obstruction Lights

OBELUX
AVIATION LIGHTS

Obelux Oy, Kutumotie 6 B, 00380 Helsinki FINLAND | The information in this document is subject to change without notice. © Obelux Oy 2016

WWW.OBELUX.COM

Mechanical characteristics

- ▶ Design degree of protection: IP65
- ▶ Painted sheet metal cabinet (400x300x200mm)
- ▶ Weight: <12kg
- ▶ EMC cable glands
- ▶ Cable glands: 5 x M25 (11-17 mm cable diameter), 4 x M20 (6-13 mm cable diameter)
- ▶ Operating temperature range: -40°C to +55°C

Electrical characteristics

- ▶ Operating voltage: 24VDC or 230VAC
- ▶ Power consumption: <10W
- ▶ Serial ports (3 x RS-485 and 1x RS-232)
- ▶ Alarm Output NO/NC dry contact 230VAC/3A
- ▶ Ethernet connection with optic fibre or standard RJ45 connection.

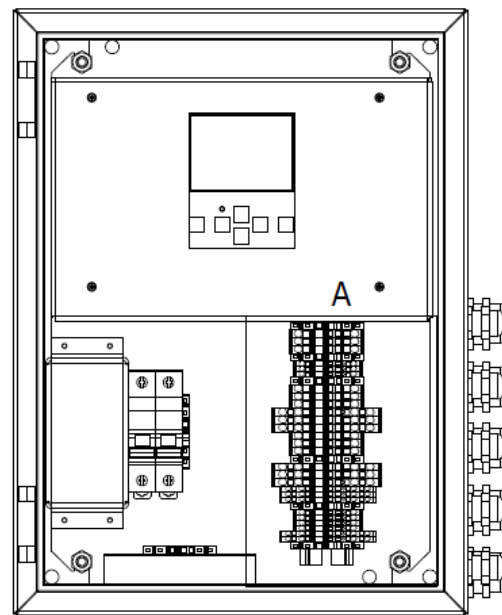

Local Controller - Aviation Light Management System

Obelux Local Controller (LC) is used for controlling and monitoring a large number of Obelux aviation lights. LC offers full system management for different devices, such as lights and visibility sensors which are connected to the same network. LC offers user-friendly color LCD screen for accessing the system locally.

Key Features

- ▶ Provides full system management for Obelux aviation lights
- ▶ Allows intensity adjustment (100% / 30% / 10%) with visibility sensor
- ▶ Serial ports (RS-485 and RS-232) and I/O signals as a standard
- ▶ Easy to connect to SCADA or Ethernet/IP network by using either optic fibre or standard RJ45 connector.
- ▶ Small and compact size
- ▶ Alarm output (dry contact)
- ▶ Overvoltage protection
- ▶ Maintenance free system

LOCAL CONTROLLER

For Obelux LED Aviation Obstruction Lights

OBELUX
AVIATION LIGHTS

Obelux Oy, Kutomotie 6 B, 00380 Helsinki FINLAND | The information in this document is subject to change without notice. © Obelux Oy 2016

WWW.OBELUX.COM

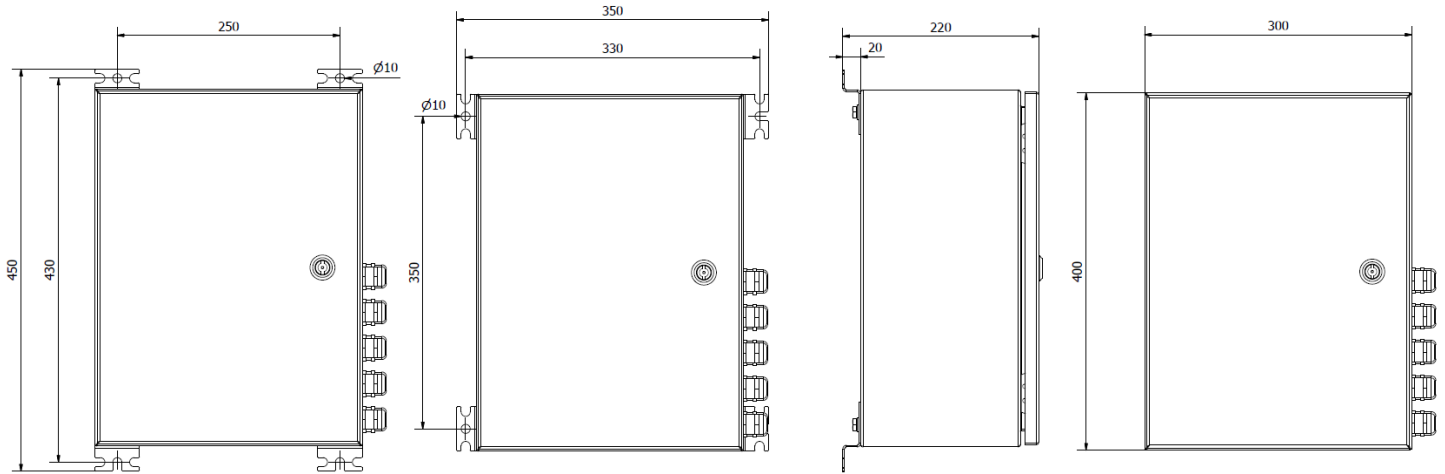

1. Cabin dimensions

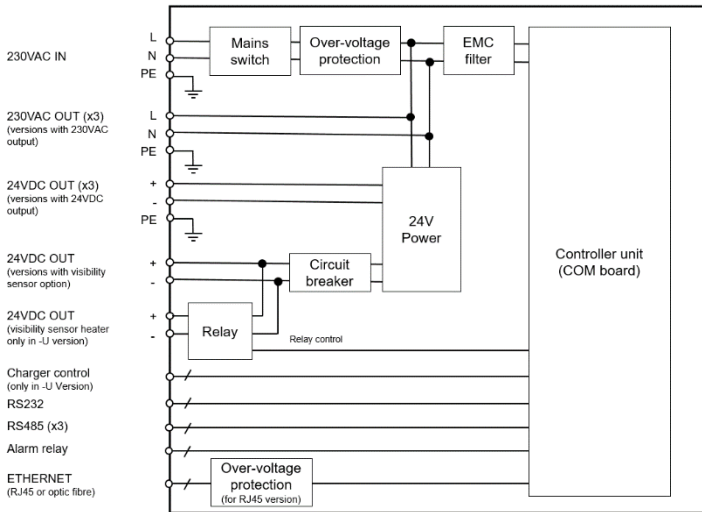

2. Block diagram of 230VAC Local Controller

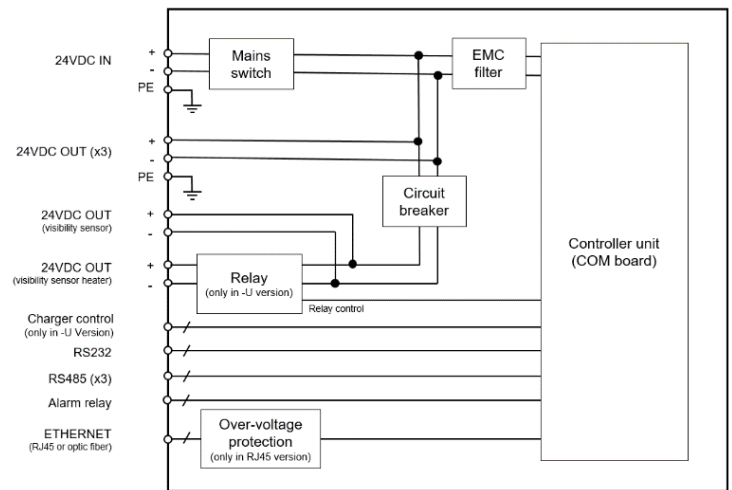

3. Block diagram of 24VDC Local Controller

Order code	Operating voltage	Output voltage	Visibility sensor heater relay	Visibility sensor support	Ethernet Connection to SCADA (RJ-45)	Ethernet Connection to SCADA (Optic fibre)	Packing dimensions
LC-230-E-S	230VAC	230VAC	No	No	Yes	No	520x420x250mm, 17kg
LC-230-EF-S	230VAC	230VAC	No	No	No	Yes	520x420x250mm, 17kg
LC-230-VE-S	230VAC	230VAC	No	Yes	Yes	No	520x420x250mm, 18kg
LC-230-VEF-S	230VAC	230VAC	No	Yes	No	Yes	520x420x250mm, 18kg
LC-230-024-VUE-S	230VAC	24VDC	Yes	Yes	Yes	No	520x420x250mm, 18kg
LC-024-VE-S	24VDC	24VDC	No	Yes	Yes	No	520x420x250mm, 17kg
LC-024-VUE-S	24VDC	24VDC	Yes	Yes	Yes	No	520x420x250mm, 17kg